



## Bend 90°, PE100 S5/SDR11

### Model:

- Conventional butt-welding according to DVS 2207 part 1
- IR = Infrared-(IR Plus®) compatible. Please choose fusion parameters: PE100
- 10 bar Gas / 16 bar Water

d [mm]	FM	Code	kg	L [mm]	L1 [mm]	R [mm]	e [mm]
20	IR	753 018 706	0.007	38	23	15	1.9
25	IR	753 018 707	0.012	42	23	19	2.3
32	IR	753 018 708	0.022	46	22	24	2.9
40	IR	753 018 709	0.038	51	21	30	3.7
50	IR	753 018 710	0.066	58	21	37	4.6
63	IR	753 018 711	0.118	66	21	45	5.8
75	IR	753 018 712	0.241	100	20	90	6.8
90	IR	753 018 713	0.358	100	20	90	8.2
110	IR	753 018 714	0.755	141	25	130	10.0
125	IR	753 018 690	0.850	140	15	125	11.4
140	IR	753 018 691	1.180	155	15	140	12.7
160	IR	753 018 692	1.750	175	15	160	14.6
180	IR	753 018 693	2.670	195	15	180	16.4
200	IR	753 018 694	3.440	215	15	200	18.2

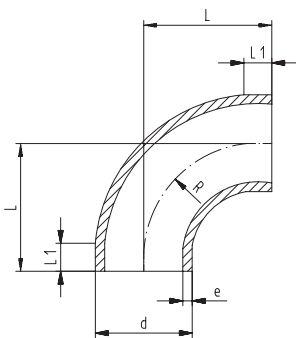

## Bend 90°, PE100 S8/8,3/SDR17/17,6

### Model:

- Conventional butt-welding according to DVS 2207 part 1
- IR = Infrared-(IR Plus®) compatible. Please choose fusion parameters: PE100
- 5 bar Gas / 10 bar Water

d [mm]	FM	Code	kg	L [mm]	L1 [mm]	R [mm]	e [mm]
50	--	753 018 635	0.052	58	21	37	2.9
63	--	753 018 636	0.084	66	21	45	3.6
75	--	753 018 737	0.172	100	20	90	4.3
90	--	753 018 738	0.243	100	20	90	5.1
110	IR	753 018 739	0.522	141	20	130	6.3
125	IR	753 018 590	0.590	140	15	125	7.1
140	IR	753 018 591	1.180	155	15	140	8.0
160	IR	753 018 592	1.750	175	15	160	9.1
180	IR	753 018 593	2.670	195	15	180	10.2
200	IR	753 018 594	3.440	215	15	200	11.4

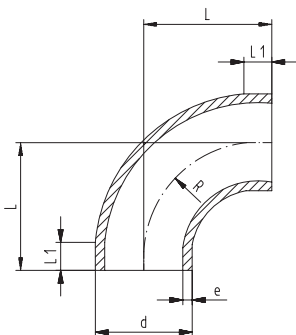

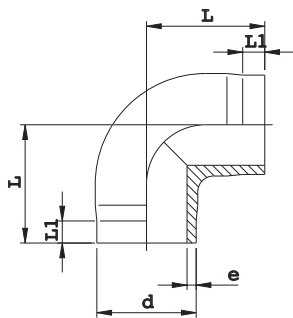

## Elbow 90°, PE100 S5/SDR11

### Model:

- Conventional butt-welding according to DVS 2207 part 1
- IR = Infrared-(IR Plus®) compatible. Please choose fusion parameters: PE100

d [mm]	FM	Code	kg	L [mm]	L1 [mm]	e [mm]
20	IR	753 108 606	0.009	38	25	1,9
25	IR	753 108 607	0.014	42	26	2,3
32	IR	753 108 608	0.025	46	27	2,9
40	IR	753 108 609	0.049	51	22	3,7
50	IR	753 108 610	0.087	58	23	4,6
63	IR	753 108 611	0.152	66	21	5,8

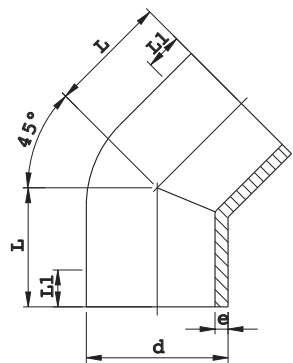

## Elbow 45°, PE100 S5/SDR11

### Model:

- Conventional butt-welding according to DVS 2207 part 1
- IR = Infrared-(IR Plus®) compatible. Please choose fusion parameters: PE100

d [mm]	FM	Code	kg	L [mm]	L1 [mm]	e [mm]
20	IR	753 158 606	0.008	32	24	1,9
25	IR	753 158 607	0.013	34	25	2,3
32	IR	753 158 608	0.021	36	25	2,9
40	IR	753 158 609	0.037	39	25	3,7
50	IR	753 158 610	0.059	42	26	4,6
63	IR	753 158 611	0.104	47	29	5,8
75	IR	753 158 612	0.147	49	29	6,8
90	IR	753 158 613	0.243	57	34	8,2
110	IR	753 158 614	0.445	70	43	10,0
125	IR	753 158 615	0.653	79	48	11,4
140	IR	753 158 616	0.905	88	55	12,7
160	IR	753 158 617	1.344	100	60	14,6
200	IR	753 158 619	2.625	124	75	18,2
225	IR	753 158 620	3.738	140	85	20,5

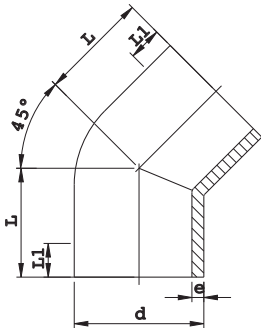

## Elbow 45°, PE100 S8,3/SDR17,6

### Model:

- Conventional butt-welding according to DVS 2207 part 1
- IR = Infrared-(IR Plus®) compatible. Please choose fusion parameters: PE100

d [mm]	FM	Code	kg	L [mm]	L1 [mm]	e [mm]
50	--	753 158 535	0.045	42	26	2,9
63	--	753 158 536	0.091	47	29	3,6
75	--	753 158 537	0.128	49	29	4,3
90	--	753 158 538	0.208	57	34	5,1
110	IR	753 158 539	0.398	70	43	6,3
125	IR	753 158 540	0.570	79	48	7,1
140	IR	753 158 541	0.825	88	55	8,0
160	IR	753 158 542	1.190	100	60	9,1
200	IR	753 158 544	2.300	124	75	11,4
225	IR	753 158 545	3.200	140	85	12,8

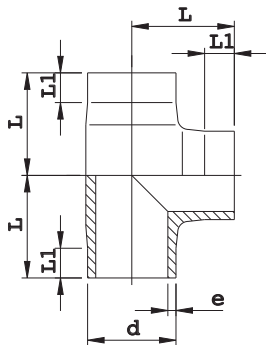

## Tee 90° equal, PE100 S5/SDR11

### Model:

- Conventional butt-welding according to DVS 2207 part 1
- IR = Infrared-(IR Plus®) compatible. Please choose fusion parameters: PE100
- 10 bar Gas / 16 bar Water

d [mm]	FM	Code	kg	L [mm]	L1 [mm]	e [mm]
20	IR	753 208 606	0.013	38	24	1,9
25	IR	753 208 607	0.021	42	26	2,3
32	IR	753 208 608	0.042	46	26	2,9
40	IR	753 208 609	0.067	51	22	3,7
50	IR	753 208 610	0.114	58	22	4,6
63	IR	753 208 611	0.203	66	21	5,8
75	IR	753 208 612	0.310	75	20	6,8
90	IR	753 208 613	0.564	90	20	8,2
110	IR	753 208 614	1.020	110	20	10,0
125	IR	753 208 615	1.514	125	25	11,4
140	IR	753 208 616	2.111	140	28	12,7
160	IR	753 208 617	3.095	160	28	14,6
180	IR	753 208 668	4.560	190	70	16,4
200	IR	753 208 619	6.037	200	35	18,2



## Tee 90° equal, PE100 S8/8,3/SDR17/17,6

### Model:

- Conventional butt-welding according to DVS 2207 part 1
- IR = Infrared-(IR Plus®) compatible. Please choose fusion parameters: PE100
- 5 bar Gas / 10 bar Water

d [mm]	FM	Code	kg	L [mm]	L1 [mm]	e [mm]
50	--	<b>753 208 535</b>	0.090	59	26	2,9
63	--	<b>753 208 536</b>	0.160	71	25	3,6
75	--	<b>753 208 412</b>	0.245	74	20	4,8
90	--	<b>753 208 413</b>	0.418	90	20	5,6
110	IR	<b>753 208 414</b>	0.757	110	20	6,9
125	IR	<b>753 208 540</b>	1.066	124	27	7,1
140	IR	<b>753 208 541</b>	1.449	141	33	8,0
160	IR	<b>753 208 542</b>	2.240	160	40	9,1
180	IR	<b>753 208 543</b>	3.176	190	70	10,2
200	IR	<b>753 208 544</b>	4.360	210	70	11,4

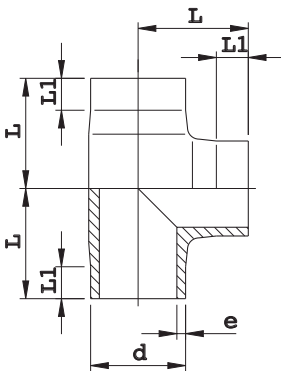

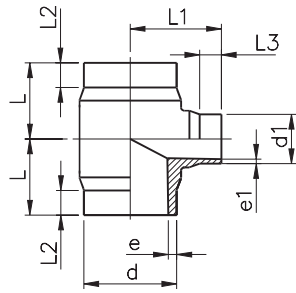

## Tee 90°, reduced, PE100 S5/SDR11

### Model:

- Conventional butt-welding according to DVS 2207 part 1
- IR = Infrared-(IR Plus®) compatible. Please choose fusion parameters: PE100
- 10 bar Gas / 16 bar Water

d [mm]	d1 [mm]	FM	Code	kg	L [mm]	L1 [mm]	L2 [mm]	L3 [mm]	e [mm]	e1 [mm]
63	32	IR	<b>753 208 351</b>	0.170	65	70	25	25	5,8	2,9
63	50	IR	<b>753 208 352</b>	0.180	65	70	25	25	5,8	4,6
75	32	IR	<b>753 208 353</b>	0.250	70	75	25	25	6,8	2,9
75	50	IR	<b>753 208 354</b>	0.263	70	75	25	25	6,8	4,6
75	63	IR	<b>753 208 355</b>	0.278	70	75	25	25	6,8	5,8
90	50	IR	<b>753 208 357</b>	0.445	80	85	25	25	8,2	4,6
90	63	IR	<b>753 208 358</b>	0.455	80	85	25	25	8,2	5,8
90	75	IR	<b>753 208 359</b>	0.470	80	85	25	25	8,2	6,8
110	32	IR	<b>753 208 360</b>	0.705	90	95	30	25	10,0	2,9
110	50	IR	<b>753 208 361</b>	0.700	90	95	30	25	10,0	4,6
110	63	IR	<b>753 208 362</b>	0.710	90	95	30	25	10,0	5,8
110	75	IR	<b>753 208 363</b>	0.723	90	95	30	25	10,0	6,8
110	90	IR	<b>753 208 364</b>	0.735	90	95	30	25	10,0	8,2
160	63	IR	<b>753 208 371</b>	2.270	142	135	50	30	14,6	5,8
160	75	IR	<b>753 208 372</b>	2.295	142	135	50	30	14,6	6,8
160	90	IR	<b>753 208 373</b>	2.315	142	135	50	30	14,6	8,2
160	110	IR	<b>753 208 374</b>	2.355	142	135	50	30	14,6	10,0
225	90	IR	<b>753 208 388</b>	4.760	155	165	40	30	20,5	8,2
225	110	IR	<b>753 208 389</b>	4.720	155	165	40	30	20,5	10,0
225	160	IR	<b>753 208 391</b>	4.780	155	165	40	30	20,5	14,6
250	110	--	<b>753 221 031</b>	8.120	228	197	140	37	22,7	10,0
250	160	--	<b>753 221 032</b>	8.620	229	219	117	60	22,7	14,6

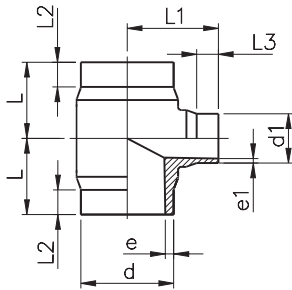

## Tee 90°, reduced, PE100 S8,3/SDR17,6

### Model:

- Conventional butt-welding according to DVS 2207 part 1
- IR = Infrared-(IR Plus®) compatible. Please choose fusion parameters: PE100
- 5 bar Gas / 10 bar Water

\* Branch SDR11

d [mm]	d1 [mm]	FM	Code	kg	L [mm]	L1 [mm]	L2 [mm]	L3 [mm]	e [mm]	e1 [mm]
* 63	32	--	<b>753 208 301</b>	0.157	65	70	25	25	3,6	2,9
63	50	--	<b>753 208 302</b>	0.158	65	70	25	25	3,6	2,9
* 75	32	--	<b>753 208 303</b>	0.240	70	75	25	25	4,3	2,9
75	50	--	<b>753 208 304</b>	0.250	70	75	25	25	4,3	2,9
75	63	--	<b>753 208 305</b>	0.257	70	75	25	25	4,3	3,6
90	50	--	<b>753 208 307</b>	0.410	80	85	25	25	5,1	2,9
90	63	--	<b>753 208 308</b>	0.330	80	85	25	25	5,1	3,6
90	75	--	<b>753 208 309</b>	0.340	80	85	25	25	5,1	4,3
* 110	32	IR	<b>753 208 310</b>	0.640	90	95	30	25	6,3	2,9
110	50	IR	<b>753 208 311</b>	0.650	90	95	30	25	6,3	2,9
110	63	IR	<b>753 208 312</b>	0.520	90	95	30	25	6,3	3,6
110	75	IR	<b>753 208 313</b>	0.524	90	95	30	25	6,3	4,3
110	90	IR	<b>753 208 314</b>	0.530	90	95	30	25	6,3	5,1
160	63	IR	<b>753 208 321</b>	2.150	142	135	50	30	9,1	3,6
160	75	IR	<b>753 208 322</b>	2.130	142	135	50	30	9,1	4,3
160	90	IR	<b>753 208 323</b>	1.590	142	135	50	30	9,1	5,1
160	110	IR	<b>753 208 324</b>	1.695	142	135	50	30	9,1	6,3
225	90	IR	<b>753 208 338</b>	3.430	155	165	40	30	12,8	5,1
225	110	IR	<b>753 208 339</b>	3.410	155	165	40	30	12,8	6,3
225	160	IR	<b>753 208 341</b>	3.440	155	165	40	30	12,8	9,1
250	160	--	<b>753 220 832</b>	6.500	228	219	117	60	14,8	9,5

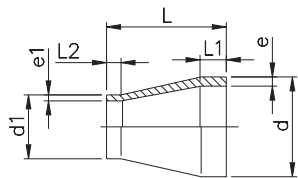

## Reducer, PE100 S5/SDR11

### Model:

- Conventional butt-welding according to DVS 2207 part 1
- IR = Infrared-(IR Plus®) compatible. Please choose fusion parameters: PE100
- 10 bar Gas / 16 bar Water
- Up to d 315 injection moulded

d [mm]	d1 [mm]	FM	Code	kg	L [mm]	L1 [mm]	L2 [mm]	e [mm]	e1 [mm]
25	20	IR	753 908 637	0.007	50	20	18	2,3	1,9
32	20	IR	753 908 642	0.010	50	20	18	2,9	1,9
32	25	IR	753 908 641	0.011	50	20	18	2,9	2,3
40	20	IR	753 908 648	0.016	58	20	20	3,7	1,9
40	25	IR	753 908 647	0.017	55	20	18	3,7	2,3
40	32	IR	753 908 646	0.019	55	20	18	3,7	2,9
50	25	IR	753 908 654	0.025	60	20	18	4,6	2,3
50	32	IR	753 908 653	0.028	60	20	18	4,6	2,9
50	40	IR	753 908 652	0.032	60	20	18	4,6	3,7
63	32	IR	753 908 660	0.046	65	20	18	5,8	2,9
63	40	IR	753 908 659	0.051	65	20	18	5,8	3,7
63	50	IR	753 908 658	0.056	65	20	18	5,8	4,6
75	40	IR	753 908 666	0.070	68	20	20	6,8	3,7
75	50	IR	753 908 665	0.074	65	20	18	6,8	4,6
75	63	IR	753 908 664	0.083	65	20	18	6,8	5,8
90	63	IR	753 908 671	0.127	75	21	17	8,2	5,8
90	75	IR	753 908 670	0.132	75	22	17	8,2	6,8
110	75	IR	753 908 677	0.226	90	28	17	10,0	6,8
110	90	IR	753 908 676	0.239	90	28	20	10,0	8,2
125	110	IR	753 908 680	0.345	100	32	26	11,4	10,0
140	110	IR	753 908 685	0.436	110	35	28	12,7	10,0
140	125	IR	753 908 684	0.478	110	35	28	12,7	11,4
160	110	IR	753 908 690	0.608	120	40	25	14,6	10,0
160	140	IR	753 908 688	0.671	120	40	33	14,6	12,7
180	90	IR	753 908 877	0.678	157	45	22	16,4	8,2
180	110	IR	753 908 878	0.556	157	45	28	16,4	10,0
180	125	IR	753 908 879	0.528	136	45	32	16,4	11,4
180	140	IR	753 908 880	0.524	136	45	35	16,4	12,7
180	160	IR	753 908 881	0.537	136	45	40	16,4	14,6
200	160	IR	753 908 692	1.266	150	50	35	18,2	14,6
200	180	IR	753 908 883	0.715	151	50	45	18,2	16,4

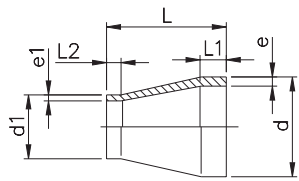

## Reducer, PE100 S5/SDR11

### Model:

- Conventional butt-welding according to DVS 2207 part 1
- IR = Infrared-(IR Plus®) compatible. Please choose fusion parameters: PE100
- 10 bar Gas / 16 bar Water
- Up to d 315 injection moulded

d [mm]	d1 [mm]	FM	Code	kg	L [mm]	L1 [mm]	L2 [mm]	e [mm]	e1 [mm]
25	20	IR	753 908 637	0.007	50	20	18	2,3	1,9
32	20	IR	753 908 642	0.010	50	20	18	2,9	1,9
32	25	IR	753 908 641	0.011	50	20	18	2,9	2,3
40	20	IR	753 908 648	0.016	58	20	20	3,7	1,9
40	25	IR	753 908 647	0.017	55	20	18	3,7	2,3
40	32	IR	753 908 646	0.019	55	20	18	3,7	2,9
50	25	IR	753 908 654	0.025	60	20	18	4,6	2,3
50	32	IR	753 908 653	0.028	60	20	18	4,6	2,9
50	40	IR	753 908 652	0.032	60	20	18	4,6	3,7
63	32	IR	753 908 660	0.046	65	20	18	5,8	2,9
63	40	IR	753 908 659	0.051	65	20	18	5,8	3,7
63	50	IR	753 908 658	0.056	65	20	18	5,8	4,6
75	40	IR	753 908 666	0.070	68	20	20	6,8	3,7
75	50	IR	753 908 665	0.074	65	20	18	6,8	4,6
75	63	IR	753 908 664	0.083	65	20	18	6,8	5,8
90	63	IR	753 908 671	0.127	75	21	17	8,2	5,8
90	75	IR	753 908 670	0.132	75	22	17	8,2	6,8
110	75	IR	753 908 677	0.226	90	28	17	10,0	6,8
110	90	IR	753 908 676	0.239	90	28	20	10,0	8,2
125	110	IR	753 908 680	0.345	100	32	26	11,4	10,0
140	110	IR	753 908 685	0.436	110	35	28	12,7	10,0
140	125	IR	753 908 684	0.478	110	35	28	12,7	11,4
160	110	IR	753 908 690	0.608	120	40	25	14,6	10,0
160	140	IR	753 908 688	0.671	120	40	33	14,6	12,7
180	90	IR	753 908 877	0.678	157	45	22	16,4	8,2
180	110	IR	753 908 878	0.556	157	45	28	16,4	10,0
180	125	IR	753 908 879	0.528	136	45	32	16,4	11,4
180	140	IR	753 908 880	0.524	136	45	35	16,4	12,7
180	160	IR	753 908 881	0.537	136	45	40	16,4	14,6
200	160	IR	753 908 692	1.266	150	50	35	18,2	14,6
200	180	IR	753 908 883	0.715	151	50	45	18,2	16,4



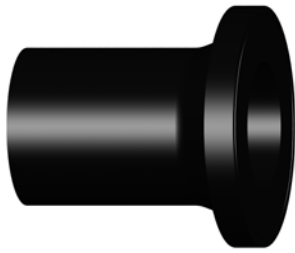

## Stub Flange LS, PE100 SDR11

### Model:

- For butt-, IR Plus® and electrofusion
- Suitable for flange connections to metric (**from d110 also to ANSI/ASME B16.5**)
- Up to d315, suitable for butterfly valve type 567,568 and 037
- Gasket: Profile flange gasket NBR No. 45 44 07, EPDM No. 48 44 07
- 10 bar Gas / 16 bar Water

\* Type B with chamfer

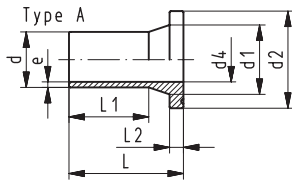

d [mm]	DN [mm]	FM	Code	kg	d1 [mm]	d2 [mm]	d3 [mm]	d4 [mm]	L [mm]	L1 [mm]	L2 [mm]	e [mm]
20	15	IR	<b>753 800 006</b>	0.022	27	45		16	85	41	7	1.9
25	20	IR	<b>753 800 007</b>	0.034	33	58		20	85	41	9	2.3
32	25	IR	<b>753 800 008</b>	0.051	40	68		26	85	44	10	3.0
40	32	IR	<b>753 800 009</b>	0.076	50	78		32	85	49	11	3.7
50	40	IR	<b>753 800 010</b>	0.107	61	88		40	104	55	12	4.6
63	50	IR	<b>753 800 011</b>	0.174	75	102		51	98	69	14	5.8
* 75	65	IR	<b>753 800 012</b>	0.300	89	122	66	61	125	89	16	6.8
* 90	80	IR	<b>753 800 013</b>	0.500	105	138	78	73	140	103	17	8.2
* 110	100	IR	<b>753 800 014</b>	0.685	125	158	100	90	160	114	18	10.0
* 125	100	IR	<b>753 800 015</b>	0.836	132	158	114	102	170	125	25	11.4
* 140	125	IR	<b>753 800 016</b>	1.295	155	188	127	114	200	147	25	12.7
* 160	150	IR	<b>753 800 017</b>	1.644	175	212	151	130	200	147	25	14.6
* 180	150	IR	<b>753 800 018</b>	1.670	180	212	158	147	200	170	30	16.4
* 200	200	IR	<b>753 800 019</b>	2.758	232	268	203	163	200	128	32	18.2